

Appendix 12. Material Assets

Appendix 12.1 – Existing Utility Drawings.

Appendix 12.2 – Proposed Infrastructure.

Appendix 12.3 – ‘MEP Engineering Report and Energy Statement, Atkins, 2022.

Appendix 12.4 – ‘*Outline Construction Waste Management Plan*’, Atkins, 2022.

Appendix 12.5 – ‘*Outline Operational Waste Management Plan*’, Atkins, 2022.

Appendix 12.1 – Existing Utility Drawings.

100
0 10
A1

DO NOT SCALE



- GENERAL NOTES**
1. ALL DIMENSIONS ARE IN MILLIMETRES UNLESS NOTED OTHERWISE
 2. ONLY WRITTEN DIMENSIONS SHALL BE USED. NO DIMENSIONS SHALL BE SCALED FROM THE DRAWINGS
 3. ALL LEVELS ARE IN METRES AND ARE TO MALIN HEAD DATUM
 4. ALL COORDINATES ARE IN METRES AND ARE TO IRISH TRANSVERSE MERCATOR

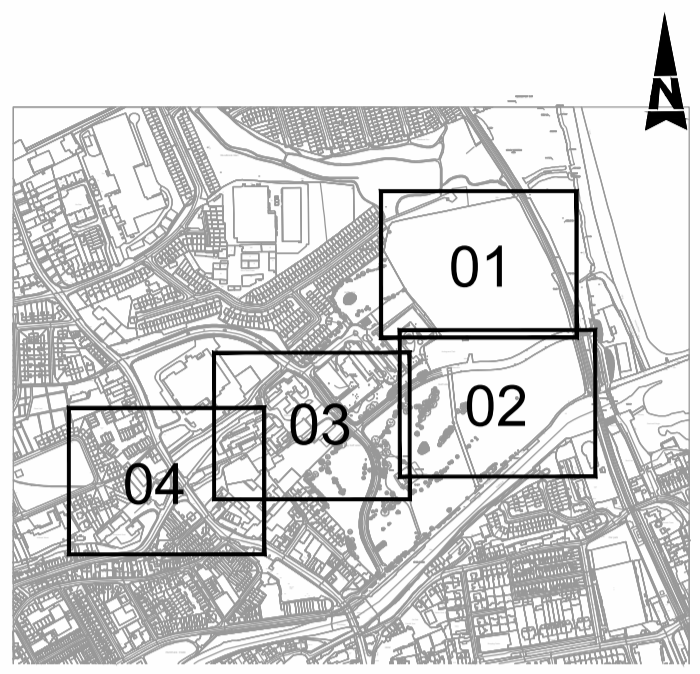

PRELIMINARY INFORMATION

- LEGEND:**
- EXISTING ESB LV UNDERGROUND
 - EXISTING ESB LV OVERHEAD
 - EXISTING ESB MV UNDERGROUND
 - EXISTING ESB MV OVERHEAD
 - EXISTING 38kv ESB UNDERGROUND
 - EXISTING EIR DUCTING
 - EXISTING FOUL SEWER
 - FOUL WAYLEAVE
 - EXISTING WATER MAIN
 - EXISTING GAS DISTRIBUTION
 - GPR SURVEY EXTENTS
 - Water Main
 - Fire Water
 - Process Water
 - Storm Water Drainage
 - Foul Sewer
 - Combined Sewer
 - Manhole Chamber
 - Telecom
 - UPC/Virgin
 - ENET/OCEAN
 - BT/ESAT
 - Colt
 - Bend / Weld
 - Oxygen Pipe
 - Gas
 - Hydrogen Pipe
 - Oil Pipe
 - Magnet
 - Adshel
 - Traffic
 - Heating Pipe
 - Public Lighting
 - GPR Anomaly
 - Unknown Cable
 - Unknown Duct
 - Nitrogen Pipe
 - Unidentified Service

- NOTES:**
1. ALL UTILITY PIPES/INFRASTRUCTURE LOCATIONS SHOWN ARE INDICATIVE ONLY. THE ACTUAL POSITION OF EXISTING UTILITIES MAY VARY AND THE PRESENCE OF OTHER UTILITIES MAY BE POSSIBLE.
 2. IRISH WATER GIVES THIS INFORMATION AS TO THE POSITION OF ITS UNDERGROUND NETWORK AS A GENERAL GUIDE ONLY ON THE STRICT UNDERSTANDING THAT IT IS BASED ON THE BEST AVAILABLE INFORMATION PROVIDED BY EACH LOCAL AUTHORITY IN IRELAND. IT SHOULD NOT BE RELIED UPON IN THE EVENT OF EXCAVATIONS OR OTHER WORKS BEING CARRIED OUT IN THE VICINITY OF THE NETWORK. THE ONUS IS ON THE PARTIES CARRYING OUT THE WORKS TO ENSURE THE EXACT LOCATION OF THE NETWORK IS IDENTIFIED PRIOR TO MECHANICAL WORKS BEING CARRIED OUT. SERVICE PIPES ARE NOT GENERALLY SHOWN BUT THEIR PRESENCE SHOULD BE ANTICIPATED. © IRISH WATER
 3. WORKS MUST BE CARRIED OUT IN ACCORDANCE WITH THE UTILITY PROVIDERS CODES OF PRACTICE AND SAFE WORKING GUIDELINES.

File: 5193890-ATK-01-ZZ-DR-CE-1530-1533.dwg
 Date: May 28, 2021 - 4:24pm
 Plotted by: KFTZpatrick

© ORDNANCE SURVEY IRELAND LICENSE No. AR 0082521.
 ORDNANCE SURVEY IRELAND & GOVERNMENT OF IRELAND

Rev	Description	By	Date	Chk'd	Auth
-	FOR INFORMATION	HV	27.05.21	PE	JOK

ATKINS
Member of the SNC-Lavalin Group

Alkins House, 150-155 Ainslie Road, Business Park, Swords, Co. Dublin
 Tel (+353) 01 810 8000 Fax (+353) 01 810 8001

Unit 2B, 2200 Cork Airport Business Park, Cork
 Tel (+353) 021 429 0300 Fax (+353) 021 429 0360

1st Floor Technology House Parkmore Technology Park, Galway
 Tel (+353) 091 786 050 Fax (+353) 091 779 830

Client	SHANKILL PROPERTY INVESTMENTS LTD
Project	COASTAL QUARTER SHD PLANNING APPLICATION

Title				EXISTING UTILITIES SHEET 1			
Original Scale	1:500 at A1 1:1000 at A3	Design/Drawn	TD	Checked	PE	Authorised	JOK
Status	I	Drawing Number	5193890-ATK-01-ZZ-DR-CE-1530	Date	22.04.21	Date	22.04.21

100
0 10
A1

DO NOT SCALE

File: 5193890-ATK-01-ZZ-DR-CE-1530-1533.dwg
Date: May 28, 2021 - 4:26pm
Printed by: KFTZpatrick



- GENERAL NOTES**
1. ALL DIMENSIONS ARE IN MILLIMETRES UNLESS NOTED OTHERWISE
 2. ONLY WRITTEN DIMENSIONS SHALL BE USED. NO DIMENSIONS SHALL BE SCALED FROM THE DRAWINGS
 3. ALL LEVELS ARE IN METRES AND ARE TO MALIN HEAD DATUM
 4. ALL COORDINATES ARE IN METRES AND ARE TO IRISH TRANSVERSE MERCATOR

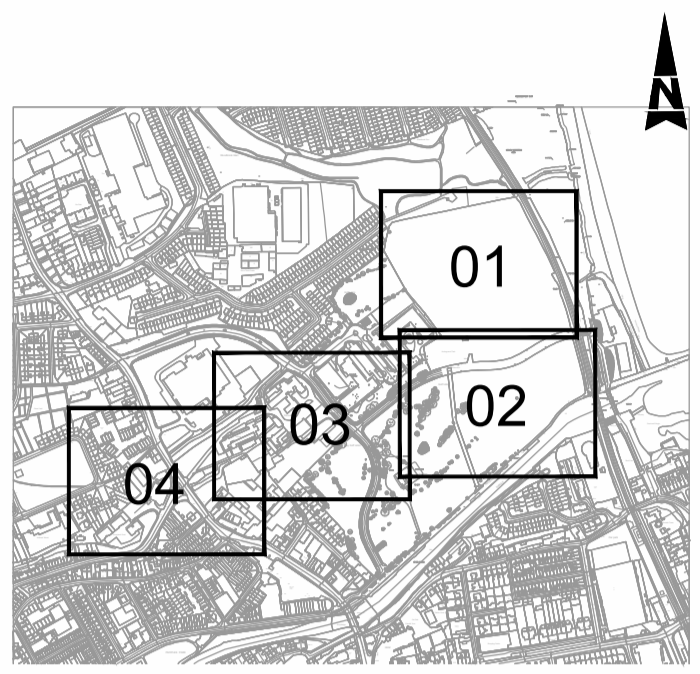

KEY PLAN
Scale NTS

PRELIMINARY INFORMATION

- LEGEND:**
- ESB LV UNDERGROUND
 - ESB LV OVERHEAD
 - ESB MV UNDERGROUND
 - ESB MV OVERHEAD
 - EXISTING 38kv ESB UNDERGROUND
 - EXISTING EIR DUCTING
 - EXISTING FOUL SEWER
 - FOUL WAYLEAVE
 - EXISTING WATER MAIN
 - EXISTING GAS DISTRIBUTION
 - GPR SURVEY EXTENTS
 - Water Main
 - Fire Water
 - Process Water
 - Storm Water Drainage
 - Foul Sewer
 - Combined Sewer
 - Manhole Chamber
 - Telecom
 - UPC/Virgin
 - ENET/OCEAN
 - BT/ESAT
 - Colt
 - Bend / Weld
 - Oxygen Pipe
 - Gas
 - Hydrogen Pipe
 - Oil Pipe
 - Magnet
 - Adshel
 - Traffic
 - Heating Pipe
 - Electrical
 - Public Lighting
 - GPR Anomaly
 - Unknown Cable
 - Unknown Duct
 - Nitrogen Pipe
 - Unidentified Service

- NOTES:**
1. ALL UTILITY PIPES/INFRASTRUCTURE LOCATIONS SHOWN ARE INDICATIVE ONLY. THE ACTUAL POSITION OF EXISTING UTILITIES MAY VARY AND THE PRESENCE OF OTHER UTILITIES MAY BE POSSIBLE.
 2. IRISH WATER GIVES THIS INFORMATION AS TO THE POSITION OF ITS UNDERGROUND NETWORK AS A GENERAL GUIDE ONLY ON THE STRICT UNDERSTANDING THAT IT IS BASED ON THE BEST AVAILABLE INFORMATION PROVIDED BY EACH LOCAL AUTHORITY IN IRELAND. IT SHOULD NOT BE RELIED UPON IN THE EVENT OF EXCAVATIONS OR OTHER WORKS BEING CARRIED OUT IN THE VICINITY OF THE NETWORK. THE ONUS IS ON THE PARTIES CARRYING OUT THE WORKS TO ENSURE THE EXACT LOCATION OF THE NETWORK IS IDENTIFIED PRIOR TO MECHANICAL WORKS BEING CARRIED OUT. SERVICE PIPES ARE NOT GENERALLY SHOWN BUT THEIR PRESENCE SHOULD BE ANTICIPATED. © IRISH WATER
 3. WORKS MUST BE CARRIED OUT IN ACCORDANCE WITH THE UTILITY PROVIDERS CODES OF PRACTICE AND SAFE WORKING GUIDELINES.

© ORDNANCE SURVEY IRELAND LICENSE No. AR 0082521
ORDNANCE SURVEY IRELAND & GOVERNMENT OF IRELAND

Rev	Description	By	Date	Chk'd	Auth
-	FOR INFORMATION	HV	27.05.21	PE	JOK

ATKINS
Member of the SNC-Lavalin Group

Atkins House, 150-155 Ainslie Road, Business Park, Swords, Co. Dublin
Tel (+353) 01 810 8000 Fax (+353) 01 810 8001

Unit 2B, 2200 Cork Airport Business Park, Cork
Tel (+353) 021 429 0300 Fax (+353) 021 429 0360

1st Floor Technology House Parkmore Technology Park, Galway
Tel (+353) 091 786 050 Fax (+353) 091 779 830

Client	SHANKILL PROPERTY INVESTMENTS LTD
Project	COASTAL QUARTER SHD PLANNING APPLICATION

Title		EXISTING UTILITIES SHEET 2			
Original Scale	1:500 at A1 1:1000 at A3	Design/Drawn	TD	Checked	PE
Date	22.04.21	Date	22.04.21	Date	22.04.21
Status	I	Drawing Number	5193890-ATK-01-ZZ-DR-CE-1531	Rev	-

100
0 10
A1

DO NOT SCALE

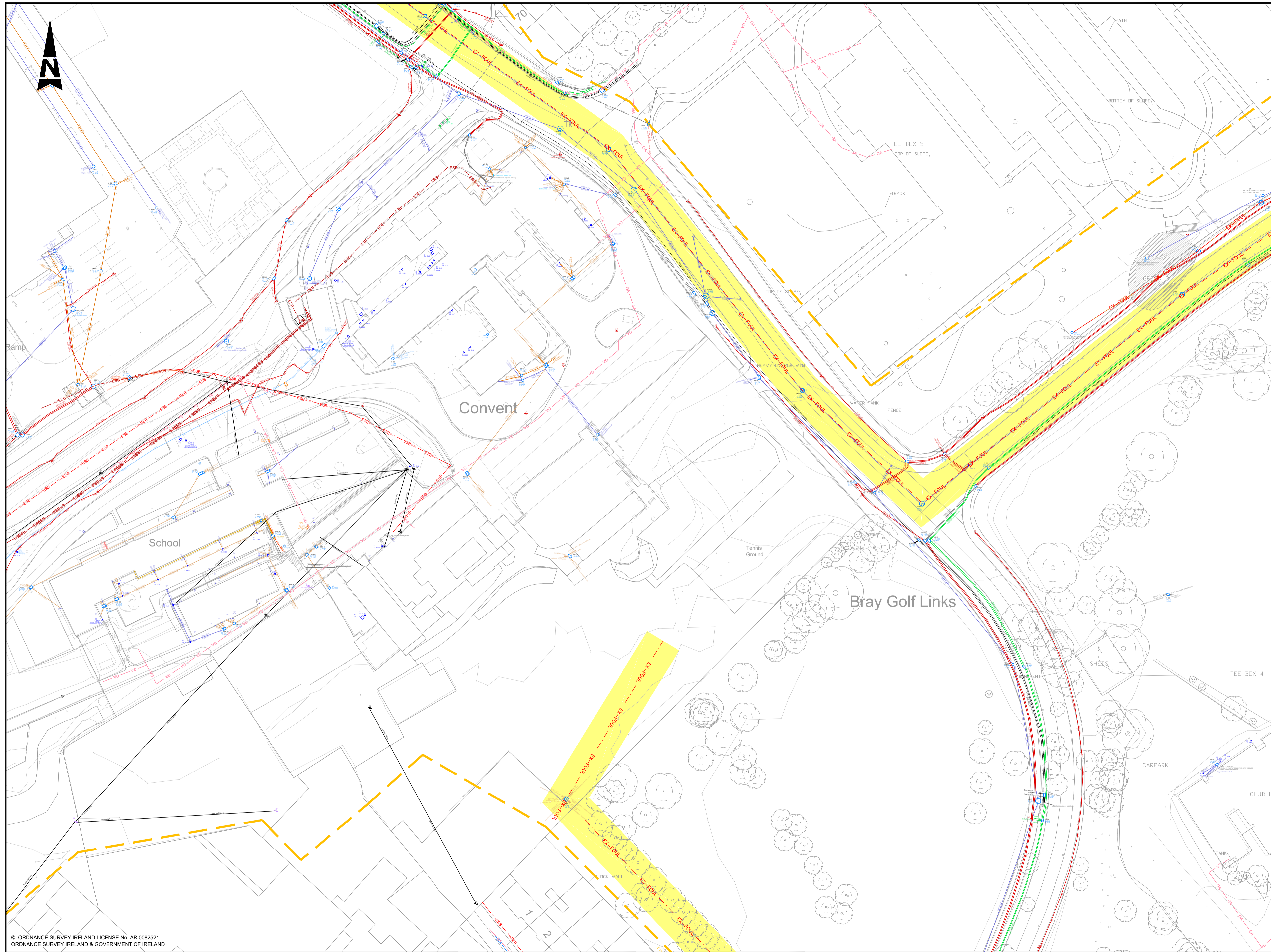

- GENERAL NOTES**
1. ALL DIMENSIONS ARE IN MILLIMETRES UNLESS NOTED OTHERWISE
 2. ONLY WRITTEN DIMENSIONS SHALL BE USED. NO DIMENSIONS SHALL BE SCALED FROM THE DRAWINGS
 3. ALL LEVELS ARE IN METRES AND ARE TO MALIN HEAD DATUM
 4. ALL COORDINATES ARE IN METRES AND ARE TO IRISH TRANSVERSE MERCATOR

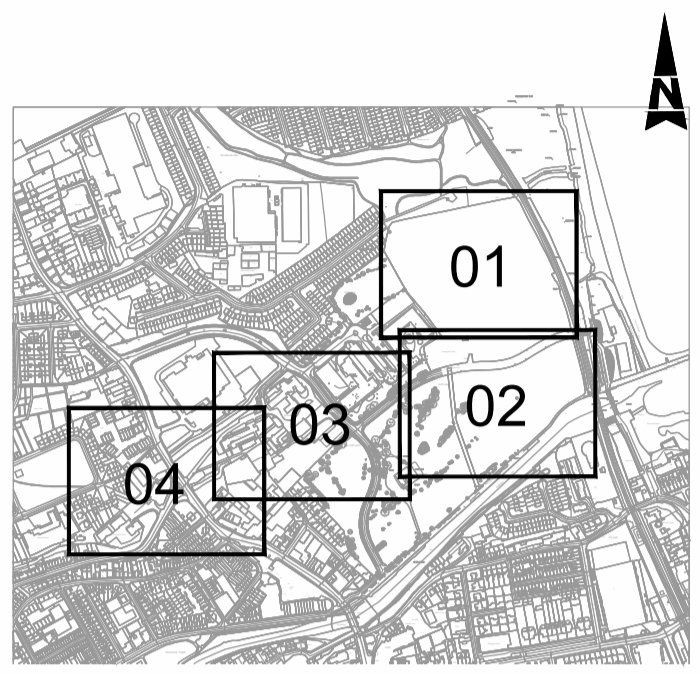

KEY PLAN
Scale NTS

PRELIMINARY INFORMATION

- LEGEND:**
- ESB-LV --- EXISTING ESB LV UNDERGROUND
 - ESB-LV --- EXISTING ESB LV OVERHEAD
 - ESB-MV --- EXISTING ESB MV UNDERGROUND
 - ESB-MV --- EXISTING ESB MV OVERHEAD
 - ESB-38kv --- EXISTING 38kv ESB UNDERGROUND
 - EI --- EXISTING EIR DUCTING
 - EX-FOWL --- EXISTING FOUL SEWER
 - FOUL WAYLEAVE
 - WM --- EXISTING WATER MAIN
 - GA --- EXISTING GAS DISTRIBUTION
 - GPR SURVEY EXTENTS
- | | |
|----------------------|----------------------|
| Water Main | Gas |
| Fire Water | Hydrogen Pipe |
| Process Water | Oil Pipe |
| Storm Water Drainage | Magnet |
| Foul Sewer | Adshel |
| Combined Sewer | Traffic |
| Manhole Chamber | Heating Pipe |
| Telecom | Electrical |
| UPC/Virgin | Public Lighting |
| ENET/OCEAN | GPR Anomaly |
| BT/ESAT | Unknown Cable |
| Colt | Unknown Duct |
| Bend / Weld | Nitrogen Pipe |
| Oxygen Pipe | Unidentified Service |

- NOTES:**
1. ALL UTILITY PIPES/INFRASTRUCTURE LOCATIONS SHOWN ARE INDICATIVE ONLY. THE ACTUAL POSITION OF EXISTING UTILITIES MAY VARY AND THE PRESENCE OF OTHER UTILITIES MAY BE POSSIBLE.
 2. IRISH WATER GIVES THIS INFORMATION AS TO THE POSITION OF ITS UNDERGROUND NETWORK AS A GENERAL GUIDE ONLY ON THE STRICT UNDERSTANDING THAT IT IS BASED ON THE BEST AVAILABLE INFORMATION PROVIDED BY EACH LOCAL AUTHORITY IN IRELAND. IT SHOULD NOT BE RELIED UPON IN THE EVENT OF EXCAVATIONS OR OTHER WORKS BEING CARRIED OUT IN THE VICINITY OF THE NETWORK. THE ONUS IS ON THE PARTIES CARRYING OUT THE WORKS TO ENSURE THE EXACT LOCATION OF THE NETWORK IS IDENTIFIED PRIOR TO MECHANICAL WORKS BEING CARRIED OUT. SERVICE PIPES ARE NOT GENERALLY SHOWN BUT THEIR PRESENCE SHOULD BE ANTICIPATED. © IRISH WATER
 3. WORKS MUST BE CARRIED OUT IN ACCORDANCE WITH THE UTILITY PROVIDERS CODES OF PRACTICE AND SAFE WORKING GUIDELINES.

© ORDNANCE SURVEY IRELAND LICENSE No. AR 0082521.
ORDNANCE SURVEY IRELAND & GOVERNMENT OF IRELAND

File: 5193890-ATK-01-ZZ-DR-CE-1530-1533.dwg
Date: May 28, 2021 - 4:28pm
Printed by: KFTZpatrick

Rev	Description	By	Date	Chk'd	Auth
-	FOR INFORMATION	HV	27.05.21	PE	JOK

ATKINS
Member of the SNC-Lavalin Group

Alkins House, 150-155 Ainslie Road, Swards, Co. Dublin
Tel (+353) 01 810 8000 Fax (+353) 01 810 8001

Unit 2B, 2200 Cork Airport Business Park, Cork
Tel (+353) 021 429 0300 Fax (+353) 021 429 0360

1st Floor Technology House Parkmore Technology Park, Galway
Tel (+353) 091 786 050 Fax (+353) 091 779 830

Client	SHANKILL PROPERTY INVESTMENTS LTD
Project	COASTAL QUARTER SHD PLANNING APPLICATION

Title				EXISTING UTILITIES SHEET 3			
Original Scale	1:500 at A1 1:1000 at A3	Design/Drawn	TD	Checked	PE	Authorized	JOK
Status	I	Drawing Number	5193890-ATK-01-ZZ-DR-CE-1532	Date	22.04.21	Date	22.04.21

A1

DO NOT SCALE

File: 5193890-ATK-01-ZZ-DR-CE-1530-1533.dwg
Date: May 28, 2021 - 4:31pm
Printed by: KFTZpatrick

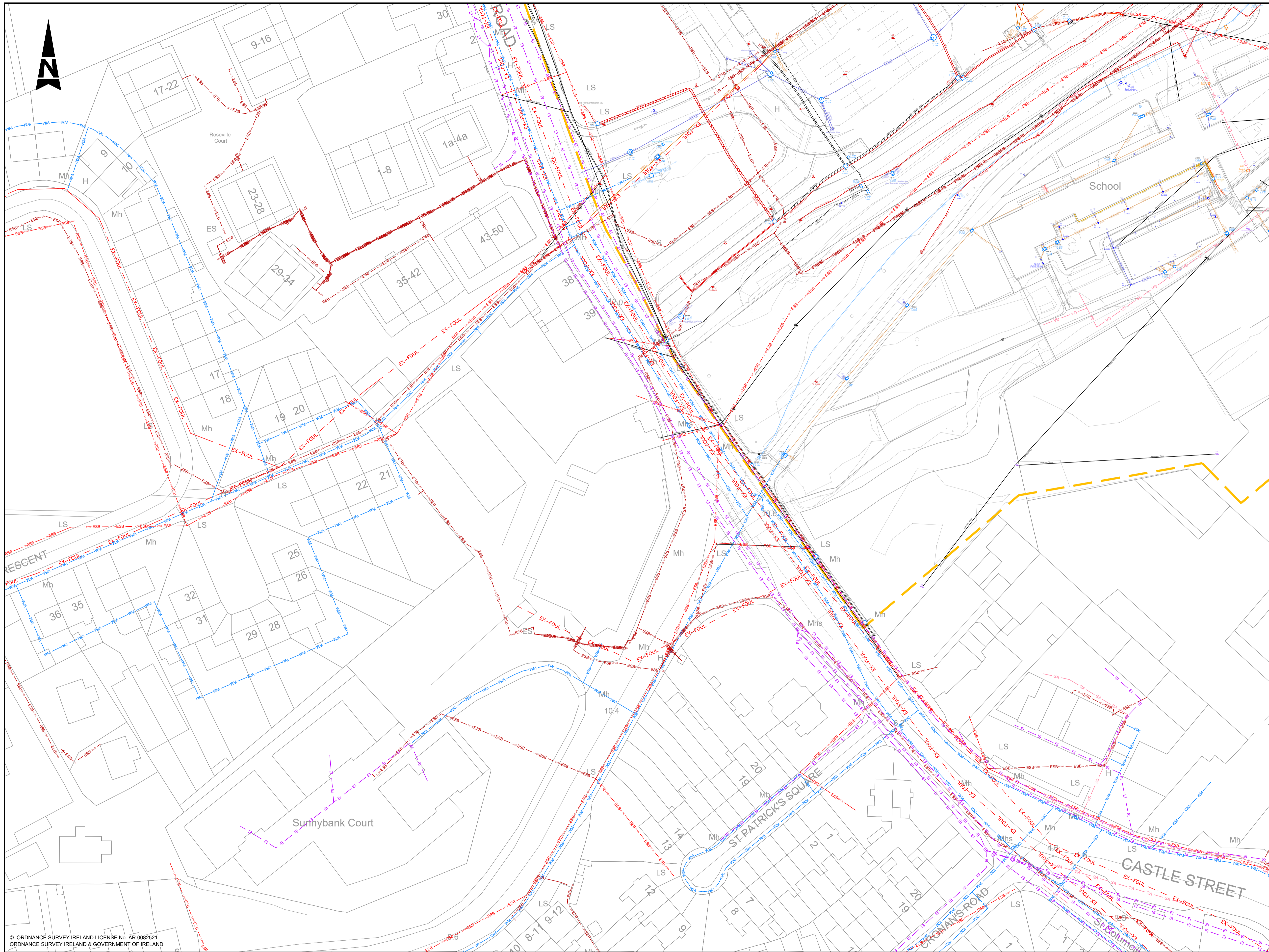

- GENERAL NOTES**
1. ALL DIMENSIONS ARE IN MILLIMETRES UNLESS NOTED OTHERWISE
 2. ONLY WRITTEN DIMENSIONS SHALL BE USED. NO DIMENSIONS SHALL BE SCALED FROM THE DRAWINGS
 3. ALL LEVELS ARE IN METRES AND ARE TO MALIN HEAD DATUM
 4. ALL COORDINATES ARE IN METRES AND ARE TO IRISH TRANSVERSE MERCATOR

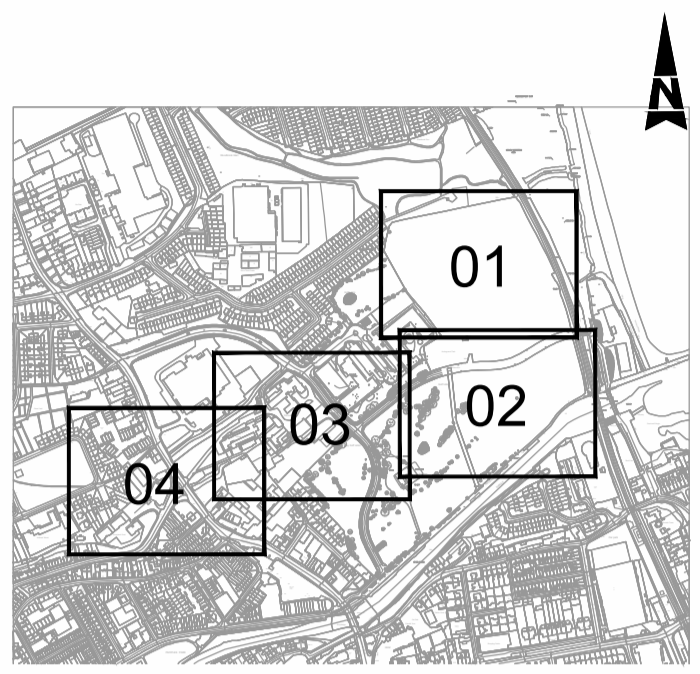

KEY PLAN
Scale NTS

PRELIMINARY INFORMATION

- LEGEND:**
- ESB LV UNDERGROUND (Red dashed line)
 - ESB LV OVERHEAD (Red solid line)
 - ESB MV UNDERGROUND (Red dashed line)
 - ESB MV OVERHEAD (Red solid line)
 - 38kv ESB UNDERGROUND (Red dashed line)
 - EIR DUCTING (Purple dashed line)
 - EXISTING FOUL SEWER (Red dashed line)
 - FOUL WAYLEAVE (Yellow dashed line)
 - EXISTING WATER MAIN (Blue dashed line)
 - EXISTING GAS DISTRIBUTION (Red dashed line)
 - GPR SURVEY EXTENTS (Yellow dashed line)
 - Water Main (Blue solid line)
 - Fire Water (Red solid line)
 - Process Water (Blue solid line)
 - Storm Water Drainage (Blue solid line)
 - Foul Sewer (Red solid line)
 - Combined Sewer (Blue solid line)
 - Manhole Chamber (Blue solid line)
 - Telecom (Black solid line)
 - UPC/Virgin (Purple solid line)
 - ENET/OCEAN (Blue solid line)
 - BT/ESAT (Purple solid line)
 - Colt (Blue solid line)
 - Bend / Weld (Black solid line)
 - Oxygen Pipe (Black solid line)
 - Gas (Orange solid line)
 - Hydrogen Pipe (Green solid line)
 - Oil Pipe (Green solid line)
 - Magnet (Green solid line)
 - Adshel (Green solid line)
 - Traffic (Green solid line)
 - Heating Pipe (Green solid line)
 - Electrical (Black solid line)
 - Public Lighting (Red solid line)
 - GPR Anomaly (Red solid line)
 - Unknown Cable (Black solid line)
 - Unknown Duct (Black solid line)
 - Nitrogen Pipe (Green solid line)
 - Unidentified Service (Red solid line)

- NOTES:**
1. ALL UTILITY PIPES/INFRASTRUCTURE LOCATIONS SHOWN ARE INDICATIVE ONLY. THE ACTUAL POSITION OF EXISTING UTILITIES MAY VARY AND THE PRESENCE OF OTHER UTILITIES MAY BE POSSIBLE.
 2. IRISH WATER GIVES THIS INFORMATION AS TO THE POSITION OF ITS UNDERGROUND NETWORK AS A GENERAL GUIDE ONLY ON THE STRICT UNDERSTANDING THAT IT IS BASED ON THE BEST AVAILABLE INFORMATION PROVIDED BY EACH LOCAL AUTHORITY IN IRELAND. IT SHOULD NOT BE RELIED UPON IN THE EVENT OF EXCAVATIONS OR OTHER WORKS BEING CARRIED OUT IN THE VICINITY OF THE NETWORK. THE ONUS IS ON THE PARTIES CARRYING OUT THE WORKS TO ENSURE THE EXACT LOCATION OF THE NETWORK IS IDENTIFIED PRIOR TO MECHANICAL WORKS BEING CARRIED OUT. SERVICE PIPES ARE NOT GENERALLY SHOWN BUT THEIR PRESENCE SHOULD BE ANTICIPATED. © IRISH WATER
 3. WORKS MUST BE CARRIED OUT IN ACCORDANCE WITH THE UTILITY PROVIDERS CODES OF PRACTICE AND SAFE WORKING GUIDELINES.

© ORDNANCE SURVEY IRELAND LICENSE No. AR 0082521
ORDNANCE SURVEY IRELAND & GOVERNMENT OF IRELAND

Rev	Description	By	Date	Chk'd	Auth
-	FOR INFORMATION	HV	27.05.21	PE	JOK

ATKINS
Member of the SNC-Lavalin Group

Alkins House, 150-155 Ainslie Drive, Business Park, Swords, Co. Dublin
Tel (+353) 01 810 8000
Fax (+353) 01 810 8001

Unit 2B, 2200 Cork Airport Business Park, Cork
Tel (+353) 021 429 0300
Fax (+353) 021 429 0360

1st Floor Technology House Parkmore Technology Park, Galway
Tel (+353) 091 786 050
Fax (+353) 091 779 830

Client	SHANKILL PROPERTY INVESTMENTS LTD
Project	COASTAL QUARTER SHD PLANNING APPLICATION

Title		EXISTING UTILITIES SHEET 4			
Original Scale	1:500 at A1 1:1000 at A3	Design/Drawn	TD	Checked	PE
Date	22.04.21	Date	22.04.21	Date	22.04.21
Status	I	Drawing Number	5193890-ATK-01-ZZ-DR-CE-1533	Rev	-